

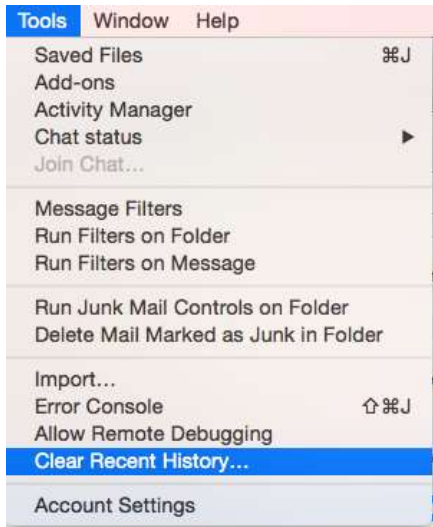

Thunderbird Email Configuration

Step 1: Open Account Settings



Launch Thunderbird, click on **Tools**, and select **Account Settings**.

Step 2: Add Mail Account

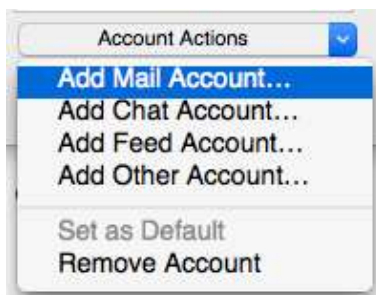

Under **Account Actions**, click **Add Mail Account...**





Step 3: Enter Account Information

Your name: Your name, as shown to others

Email address:

Password:

Remember password

Enter the following information:

Your Name:

This is the name that will appear on all outgoing mail from the account.

Email Address:

Enter your full email address.

Password:

Enter the password for your email address.

Click **Continue**





Step 4: Enter Account Information

Your name: Your name, as shown to others

Email address:

Password:

Remember password

 **Thunderbird failed to find the settings for your email account.**

| | Server hostname | Port | SSL | Authentication | |
|-----------|---|---|---|--------------------------------------|---|
| Incoming: | <input type="text" value="IMAP"/> | <input type="text" value="mail.hostedemail.com"/> | <input type="text" value="993"/> | <input type="text" value="SSL/TLS"/> | <input type="text" value="Autodetect"/> |
| Outgoing: | <input type="text" value="SMTP"/> | <input type="text" value="mail.hostedemail.com"/> | <input type="text" value="465"/> | <input type="text" value="SSL/TLS"/> | <input type="text" value="Autodetect"/> |
| Username: | Incoming: <input type="text" value="user@example.com"/> | | Outgoing: <input type="text" value="user@example.com"/> | | |

Enter the following information:

Incoming Protocol: IMAP or POP3 as per your preference. We recommend IMAP.

Server Hostname: email.isoc.net

Port:

993 (incoming IMAP)

995 (Incoming POP3)

465 (outgoing)

SSL: SSL / TLS

Authentication: Autodetect

Username: Your full email address

Once you are finished, click **Re-Test**. Thunderbird will test your account settings and account creation will be complete.

