

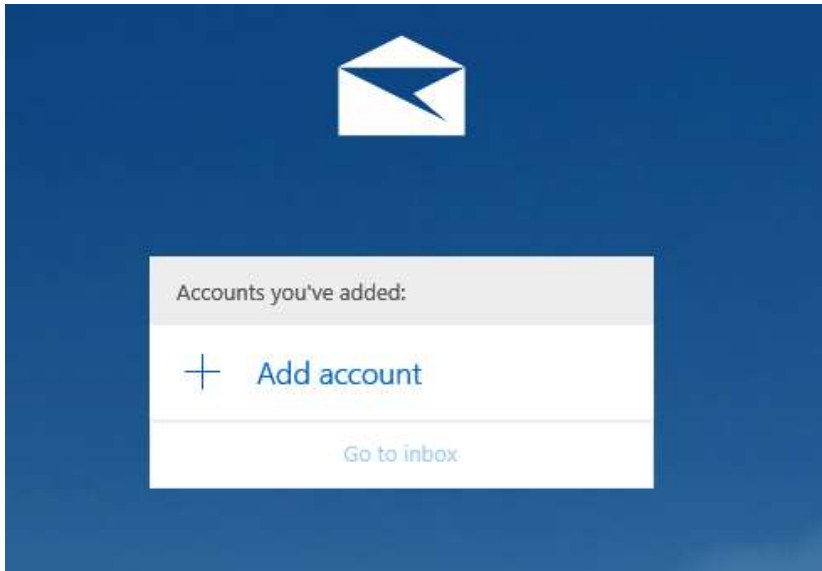

Windows 10 Mail - Email Configuration

Step 1: Open the Mail application



Click **Add Account**





Step 2: Select Account Type

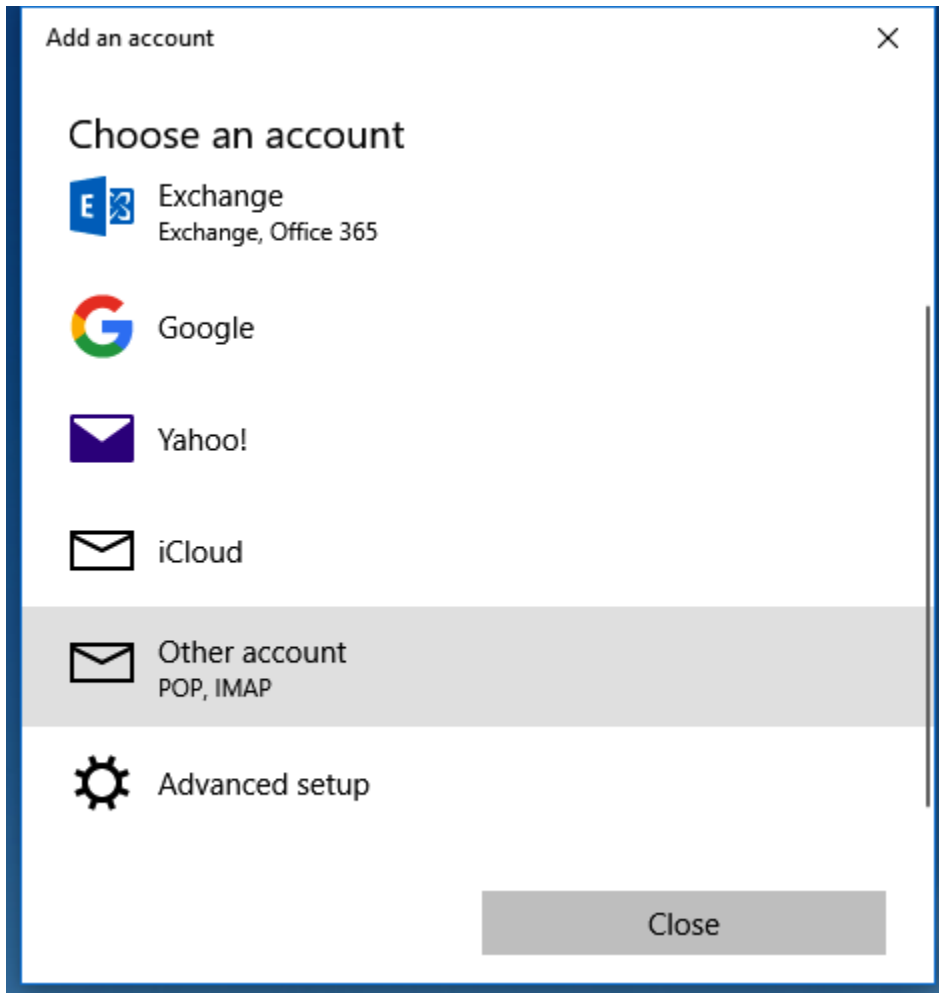

Select **Other Account**





Step 3: Enter Account Details

Add an account ✕

Other account

Email address

Send your messages using this name

Password

We'll save this information, so you don't have to sign in every time.

Enter your mailbox username, display name, and password. Then click **Sign In**

If Windows is unable to automatically detect the correct connection settings, you may be required to enter advanced account settings. You may enter the above information.





Step 4: Enter Advanced Account Information

Add an account

Internet email account

Email address
user@example.com

User name
Example User
Examples: kevinc, kevinc@contoso.com, domain/kevinc

Password

Account name
Example User

Send your messages using this name
Example User

Incoming email server
mail.hostedemail.com

Account type
IMAP4

Outgoing (SMTP) email server
mail.hostedemail.com

Outgoing server requires authentication

Use the same user name and password for sending email

Require SSL for incoming email

Require SSL for outgoing email

Cancel Sign in

Incoming Mail Servers: email.isoc.net

Outgoing Mail Server: email.isoc.net

The mailbox is now configured for access in Windows 10 Mail.

